

Note:
Most completed containers will not have the axle and wheels installed. They will be sent in the stack of containers to be assembled at their destination.

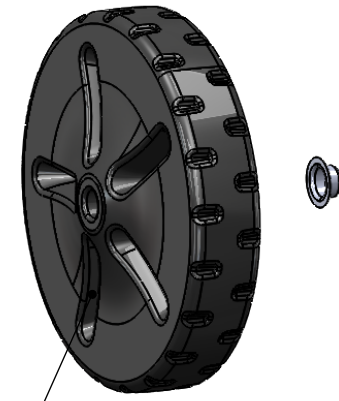

Five recesses towards the container.

Install one cap onto the axle first then slid one wheel onto the axle so that the correct side of the wheel will face the container when installed. Then insert the axle assembly into the axle holes of the container, slide on the other wheel and install the axle cap.

When installing axle caps use a mallet such as a dead blow or a block of wood between the cap and a hammer to keep from distorting the axle cap.

Wheel and axle assembly for 65/95 gallon Stealth2 container www.bearicuda.com